

C. S. F. File No. \_\_\_\_\_

A24-5(680)

**UNITED STATES FLEET  
SCOUTING FLEET 11-CM  
U. S. S. TEXAS, Flagship**

Guantanamo Bay, Cuba,  
April 15, 1927.

From: Commander, Scouting Fleet. ~~X~~  
To : Commander-in-Chief, U.S. Fleet.  
Subject: U.S.S. Texas - flag bridge.  
Enclosure: (A) 3 blue prints of suggested arrangement of flag bridge - herewith.

1. When the Texas was undergoing major alterations, considerable thought was given the arrangement of flag bridge and flag plot. It was thought at the time that the flag bridge was too low, but as it had been stated that the Texas would be only a temporary Fleet Flagship, the existing flag bridge was accepted with a new flag plot constructed thereon.

2. In view of the fact that the Texas is to be the Flagship of the Commander-in-Chief, U.S. Fleet, it is considered that a better arrangement of the flag bridge is essential.

3. With the present arrangement, the vision is restricted, the height above the water-line is not great enough, interference is caused by signalmen on the same level, and communication with the navigating bridge is difficult. Furthermore the present bridge level is subject to spray, wind and gun blast.

4. Enclosure is forwarded for the consideration of the Commander-in-Chief, U.S. Fleet. It is believed the suggested arrangement would be satisfactory and that the necessary changes could be made at small cost. It is to be noted that the raising of the navigating bridge level, as indicated on enclosure, is now approved, owing to interference with director periscope in conning tower.

S24-6 (680)

U.S.S. TEXAS

11-CM

From: C.S.F.  
To : C-in-C, US Fleet.  
Subject: U.S.S. Texas - flag bridge

-----

5. The proposed arrangement would leave the present flag plot and bridge radio station where now located, on the flag bridge level, the present flag plot to be used in conjunction with the bridge radio station.

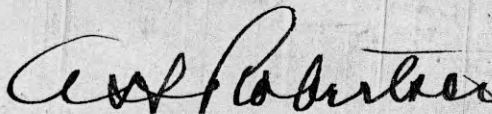

A. H. ROBERTSON.

Copy to:  
CO Texas (with copy of enclosure)

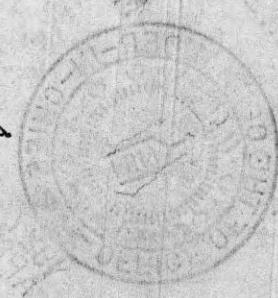



824-6(680)

CinC File No.

UNITED STATES FLEET  
U. S. S. SEATTLE, Flagship

23-Rd-(0)  
RECEIVED

BB35/L9-3(6)  
FIRST ENDORSEMENT.

At sea, Guantanamo-Gonaives

APR 18 1927

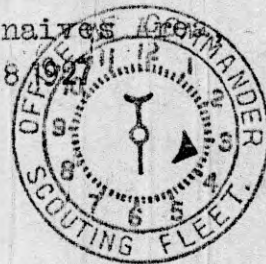

From: Commander-in-Chief, U.S. Fleet:  
To : Commander, Scouting Fleet.  
Subject: USS TEXAS - Flag Bridge.

1. Returned.

APR 21 1927

2. The Commander-in-Chief, U.S. Fleet, is in accord with the Commander, Scouting Fleet, with respect to the location of the proposed flag bridge but desires the following modifications in the arrangement:

- (a) Space forward of the mast to be used as a flag plot and space aft of mast to be used as a radio room.
- (b) Port door as shown on print between plotting spaces to be changed to a window for passing messages between flag plot and radio room.
- (c) Suitable wind protection around bridge and some sort of overhead protection to be provided.
- (d) The present plot and radio room to be converted into emergency cabins for the Commander-in-Chief and Chief of Staff.

3. It is requested that the Commander, Scouting Fleet, take the necessary action to have these changes made during the time the TEXAS is at the Navy Yard, 1-30 June.

*C. F. Hughes*  
C. F. HUGHES.

BB35/L9  
BB35/S24-6

## First Endorsement

From: Bureau of Construction and Repair.  
To: Secretary of the Navy.  
Via: Chief of Naval Operations.

MAY 5 - 1927

Subject: USS TEXAS -(BB35) - Flag Bridge. (Comdr. S.F. let.,  
Apr. 28/27, S24-6(680).)

Reference:  
(a) C.N.O. let., Op-38-A-MW; BB35/A4-3(2) (270312),  
March 12/27.

## Enclosures (herewith):

- (A) Comdr. S.F. let., Apr. 15/27, A24-6(680 to CinC,  
U. S. Fleet.
- (B) CinC, U.S.Fleet 1st end., Apr. 18/27, BB35/L9-3(6),  
to Comdr. S.F.
- (C) Suggested arrangement of Flag Bridge - 1 bp.(original).
- (D) Suggested arrangement of Flag Bridge - 1 marked bp.

1. The attached letters from the Commander, Scouting Fleet, and the Commander-in-Chief, U.S.Fleet, were delivered to the Bureau by hand, without the latter's formal endorsement, but with an oral statement concurring in the recommendations contained in the correspondence.

2. Reference (a) assigned the TEXAS as flagship of the Commander-in-Chief, United States Fleet, in lieu of the SEATTLE.

3. The present flag bridge on the TEXAS is on the same level as has been the case on that vessel since first commissioned in 1914. It is not, however, in general location and height, in accord with the spirit of the 1924 Ship Control Board's report. As the TEXAS has not been designated as other than a stand-by flagship, the necessary expenditures for provision of modern flag bridge arrangements were not considered justified. The plan proposed herewith would mark a new departure in location of flag bridge not in accordance with the letter or spirit of the Ship Control Board report, which calls for the flag bridge at or about the level of the conning tower. Heretofore the ship's navigating bridge has been located on the highest main level of the bridge structure. The proposal herein would place the flag bridge more than two decks above the conning tower level and on a level above the ship's navigating bridge. In the particular case of the TEXAS, as a matter of expediency to provide a more satisfactory



BB35/L9 (DB)  
BB35/S24-6

flag bridge, the Bureau can see no objection to this departure from the intent of the Ship Control Board's report. The Bureau does not believe, however, that in principle the flag bridge should be placed on a higher level than the navigating bridge, as in many designs this would result in an undue height of bridge structure.

4. A very approximate estimate for the cost of the work requested herein is \$30,000, of which approximately \$10,000 will eventually be expended in any case for providing a greater clearance between the bottom of the navigating bridge and the main battery director scope in the fire-control tower. The Bureau's funds, however, will not permit expenditures of this size on the TEXAS during the month of June without interfering with other necessary expenditures. If, however, in the opinion of the Navy Department, the work involved herein is of sufficient urgency, the work can probably be done if authorized at once, in advance of the arrival of the vessel at the Yard. In this case, work on other vessels at other Yards will be curtailed accordingly.

5. These estimates of time and money have been made without consultation with the Norfolk Navy Yard, but are believed to be sufficiently accurate to permit a decision.

6. The characteristics for a flagship for the Commander-in-Chief, United States Fleet, have not as yet been standardized. The TEXAS is the third type of ship assigned to this duty. If the TEXAS is to remain permanently on this assignment, it is the opinion of the Bureau that all changes necessary for the efficient performance of this duty should be made. If, however, this is a temporary assignment pending the selection of another type of vessel, the alterations on the TEXAS for this duty should be held to an absolute minimum, in view of the present shortage of funds. Further information in regard to the Department's policy in this connection is requested.

NAVY DEPARTMENT  
SECY'S OFFICE - RECORD DIV.  
RECEIVED

*Geo. H. Rock*

Copy to: CinC U.S. Fleet.

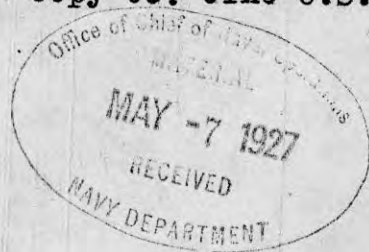

OP.  
J. A. G.  
SOL.  
S. O.  
APPT.



EST.  
PTG.  
ADV.  
SUPPLY  
SECY.  
A. S.

Geo. H. ROCK,  
Acting Chief of Bureau

SECOND DIVISION  
RECORDS & COMM.

NAVY DEPARTMENT

MAY 8 1927

BB35/S24-6(270505)

Op-23A-S  
BB35/S24-6(270505)

2nd Endorsement.

MAY 11 1927

From: Chief of Naval Operations.  
To : Secretary of the Navy.

SUBJECT: USS TEXAS (BB35) - Flag Bridge.

1. Forwarded, recommending that the suggested alterations, necessary to provide a satisfactory flag bridge and flag plotting room, be approved.

*C. W. E. E. E.*

Op-23A-S  
BB35/S24-6(270505)

3rd Endorsement.

MAY 11 1927

From: Secretary of the Navy.  
To : Chief of Bureau of Construction and Repair.

SUBJECT: USS TEXAS (BB35) - Flag Bridge.

1. The recommendation of the Chief of Naval Operations, as contained in the 2nd endorsement hereon, is approved.

2. In view of the shortage of Construction and Repair funds for the present fiscal year, the availability of the TEXAS at the Navy Yard, Norfolk, will be extended into July as long as is necessary to permit completion of this work, without diverting this year's funds from other necessary work.

*James S. Sweetman*

MAY 15 3 12 PM '27

BB35/S24-6(270505)



Flag Bridge  
and AA Control Platform

Signal Bridge

-- Old line of Pilot House --

Scale  $\frac{1}{8}" = 1'$

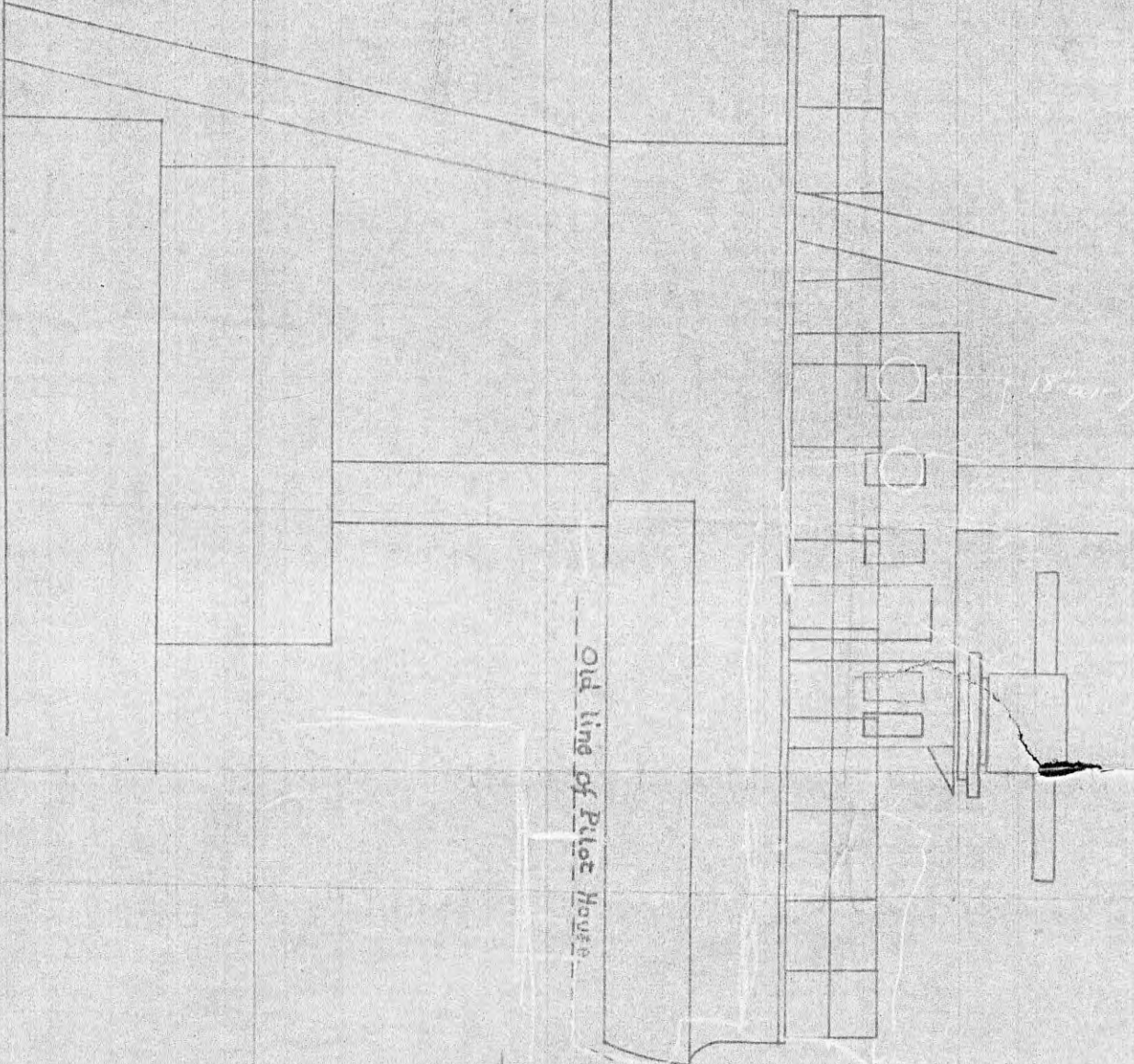

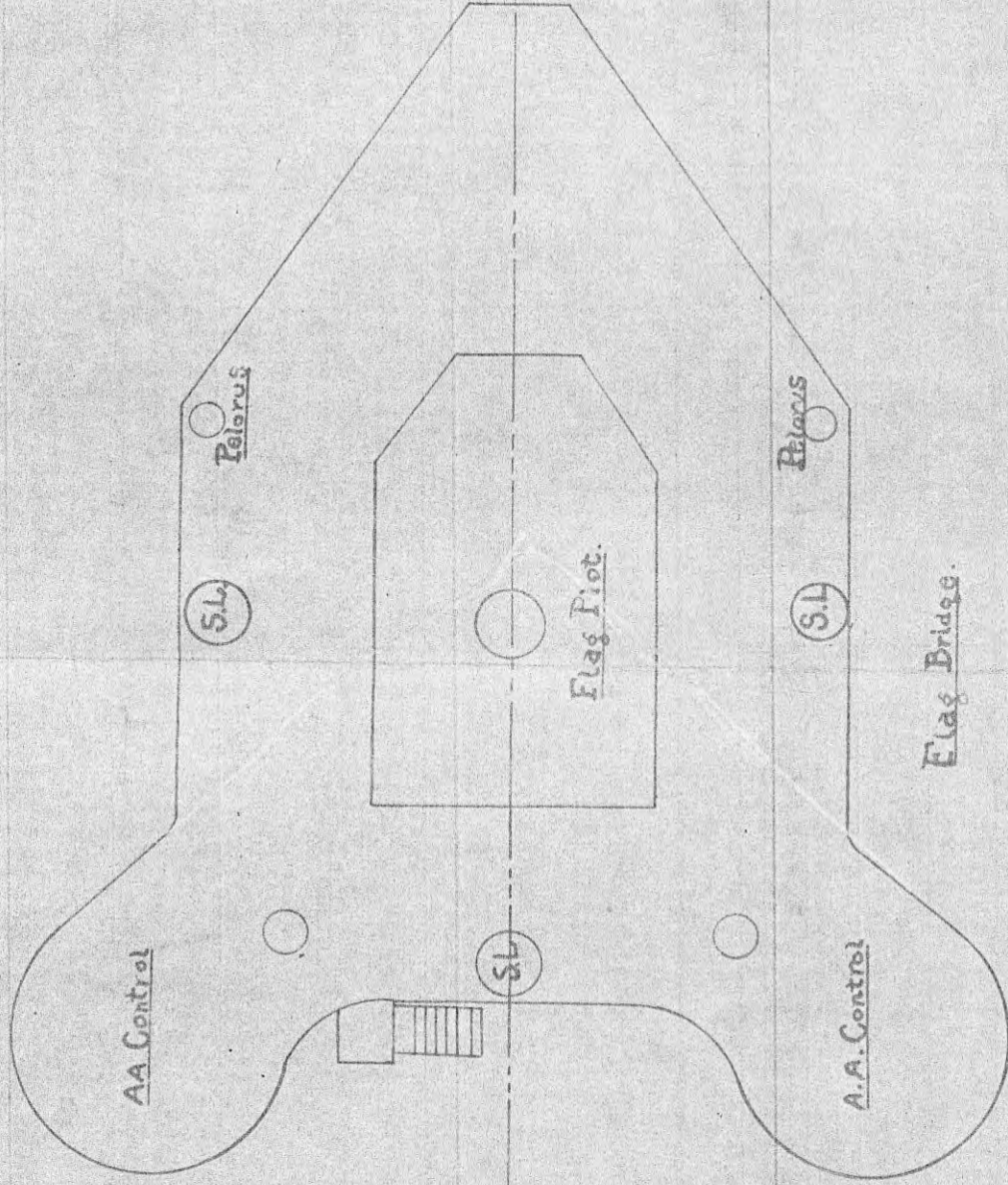

U.S.S. Texas

Plan of Proposed Flag Bridge  
and Flag Plot.

11 April 1927.



Strategical Plotting.  
Fleet Tactical Plotting.

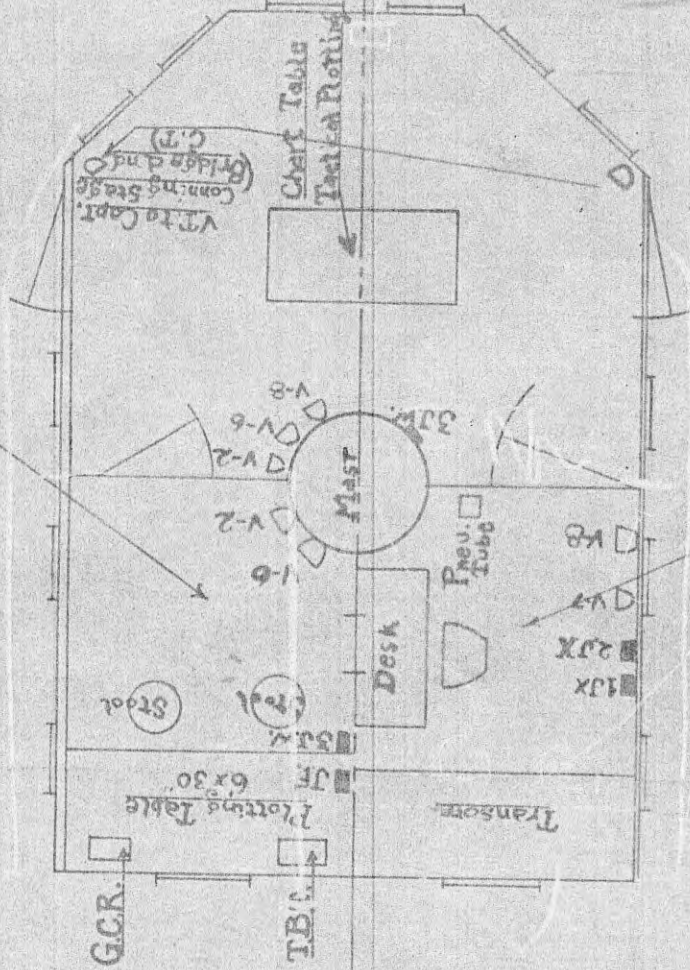

Information Center

Plan of Flag Plot